



CHARGING EQUIPMENT

User manual

ICU Compact

Congratulations with your new ICU Compact

This high-tech product has been carefully developed, assembled and tested by engineers of ICU in the Netherlands to charge your electric vehicle.

This user manual is intended to provide assistance in regards to the operation and functionalities of your charging station. Before using your new charging station, please read this manual carefully.

We wish you many safe and pleasant electric kilometres

ICU Charging Equipment

The ICU Compact







Getting started

Your charging station has been installed according to the installation guidelines. The charging station is therefore ready to charge your electric vehicle. If, for any reason, your charging station has not been turned on, please follow these steps:

1. Make sure the group in your meter box, to which your charging station is connected, is turned on;
2. The LED icons will first light up red shortly, then turn to constant red. Hereafter, the other three LED symbols will light up (green, light blue, blue) and finally, red again. The start-up process takes about 10 seconds;
3. The ICU Compact is ready for use.

Status of the charging station

The ICU Compact is equipped with status LEDs on the front cover, which indicate the status of the charging station. Below, you will find an overview of the different statuses that the charging station can display.

Status LED	Description
Off	Available
	Available, temporary status to indicate that the connection between the vehicle and the charging station has been made.
	Communication between the vehicle and the charging station is taking place.
	The vehicle is being charged.
 Flashing rapidly	There is a possible user error or the charging card is not authorized.
	The charging station has detected an error. Please refer to the 'Frequently Asked Questions' in this manual.

Operating your charging station

The ICU Compact is available in two different types of authorization. Below, you will find a description of the charging process for each type.



Plug & Charge



RFID

Plug & Charge

Start

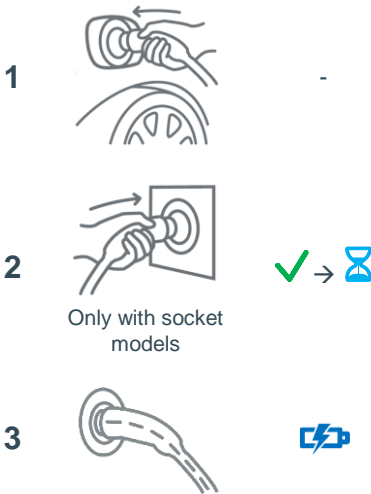

Stop

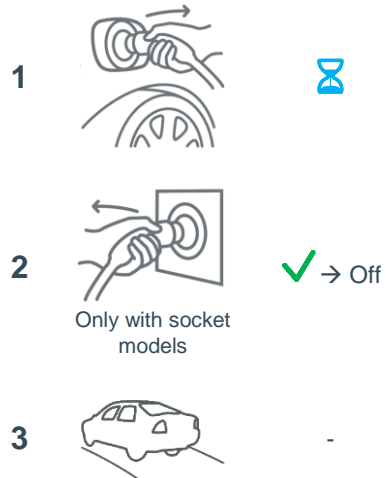

RFID

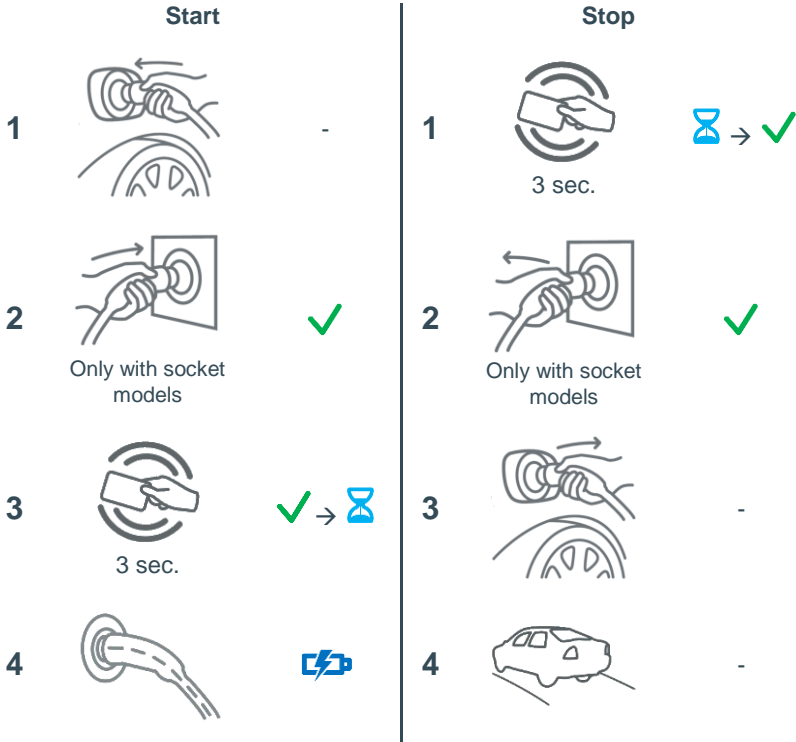

Which cards are authorized?

There are two possible settings for the authorization of charging cards:

- The charging station has been pre-programmed with only its originally supplied cards. In this case, you can only charge at this charging station with the supplied ICU cards;
- The charging station is open for public use and has a connection with CIR (Central Interoperability Register) which allows access to charging cards of all major providers. This option is available in combination with ICU EZ. This back office system manages the access to the station.

Please note: After authorizing a charging card, you have 2 minutes to insert the plug. Has the plug not been inserted after this time? Then the charging session will be ended for safety reasons and to prevent that other users can charge with your card. You can restart the charging process.

kWh-meter

The ICU Compact is optionally equipped with a kWh-meter, which shows the consumption of energy. The kWh-meter shows the total amount of energy consumed. On the right is an example of the meter showing a consumption of 12.34 kWh. It is not possible to reset or re-program the kWh-meter for a periodic reading.

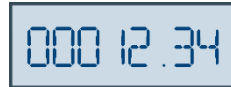

Frequently Asked Questions

Below is a list of frequently asked questions about the ICU Compact with their corresponding answers.

Description	Explanation
Where do I hold my charging card and for how long?	Located on the front of the ICU Compact is the card reader illustrated with a symbol (see illustration). Hold your card still and horizontal in front of the reader for 3 seconds until you hear a signal.
The charging station does not start up	The charging station is possibly not supplied with power. Check if the group in your meter box is on.
The car does not charge	Check if the plug has been properly inserted in the car and/or charging station.
After a few minutes, the charging session is ended abruptly	The vehicle indicates when the charging session can start. The car's battery is possibly full or the charging session is postponed
When holding the charging card in front of the card reader, the red cross icon flashes	The charging card is not authorized. Please contact the reseller from whom you have purchased the charging station.



Contact

Do you have a different question than the ones described in this manual or would you like to learn more about the functionalities of your ICU Compact? Please contact your installer or the reseller from whom you have purchased the charging station. For the quickest support, please keep the serial number of your product at hand. This number can be found on the side of the charging station.



www.ICU-charging-equipment.com

Any changes and/or errors are explicitly reserved

Copyright © 2015 ICU Charging Equipment